

Description

22 System Tool is designed to remove all 22 System Ø35 devices from the mounting plates without disturbing the surface finish of the wall. Simply insert and gently pull. The tool will disengage the locking tabs on the mounting plate and allow for removal. See Repair guide for detail instructions.

Materials

Stainless steel tool, silicon protective cover.

Finishes

Brushed stainless steel.

Patents

US # 7,956,295 B2 & 8,912,439 B2
Worldwide utility patents pending.

Diagram

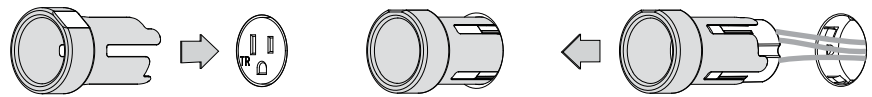

- The included sticker with QR code shall be added to the circuit directory panel recording the location of the removal tool.

Dimensions

