

Single Mounting Plate — Ø35 Furniture



22.2.64

Description

The Furniture Adjustable Plate is designed for direct installation into furniture with material thickness 0.25mm to 33.75mm. The mounting plate will accommodate 22 System 22.9.XX Ø35 devices.

Installation

Furniture
Designed for use without an electrical box.

Materials

Polycarbonate

Finishes

Black

Patents

US # 7,956,295 B2 & 8,912,439 B2
Worldwide utility patents pending.

Certifications



Dimensions

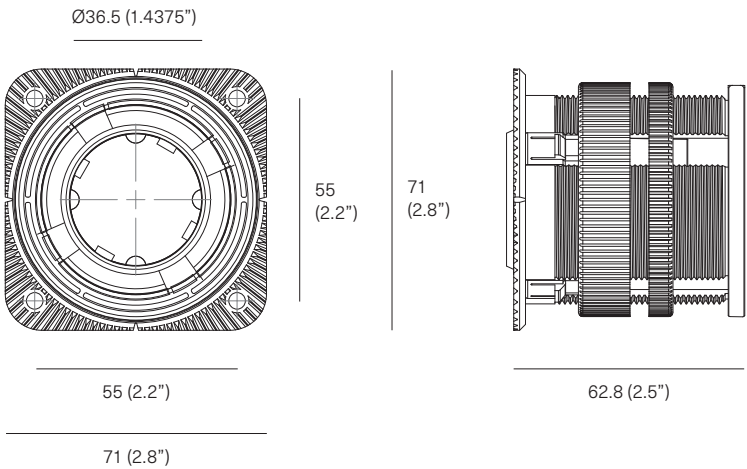

single
22.2.64