

Installation Instruction—Worldwide: Furniture



22

This instruction manual is designed for the following products: 22.9.XX

A Furniture Power Distribution Unit is not for permanent installation as part of the building structure and not for mounting in a permanently-installed furnishing such as a fixed countertop.

NOTE: The 22 System is a departure from conventional cover plate systems, and requires a licensed electrician and precise and skilled craftsmanship during installation. If you have never installed a 22 System device, we recommend a practice installation.

1. At the designated outlet location, locate and router the hole or reveal in the substrate. Compatible with material thicknesses ranging from 0.25 mm to 33.75 mm.

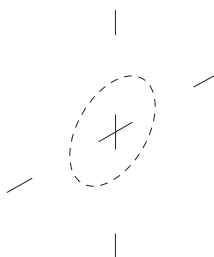

2. Position the mounting plate over the opening, ensuring it is level.

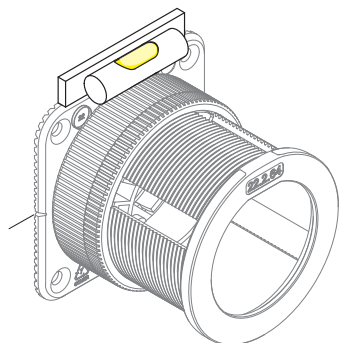

3. Attach the plate to the substrate using screws, adhesive, or other suitable fasteners. For substrates other than wood, construction adhesive is recommended.

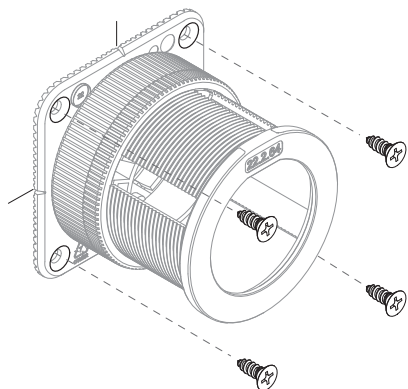

4. Insert the outlet into the plug chassis. Adjust the depth ring until the plug face sits flush with the substrate.

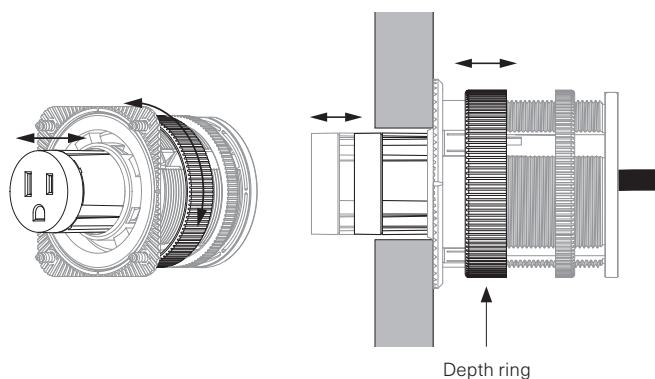

5. Optional. To preset the correct depth, place a sample piece of the substrate between the end cap and lock ring.

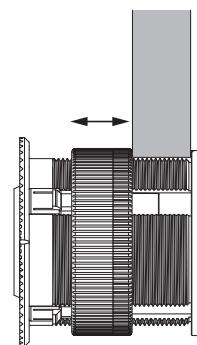

Installation Instruction—Worldwide: Furniture

22

6. Rotate the lock ring until it engages with the depth ring under light pressure. This secures the assembly and prevents movement during use.

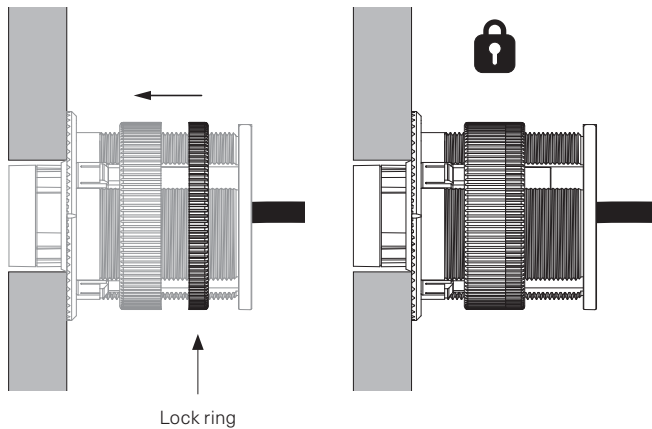

7. Plug the furniture plug into the power source.



8. **IMPORTANT: The 22 System Tool (sold separately) is required for inspection and maintenance. Refer to the Removal Guide for detailed instructions.**

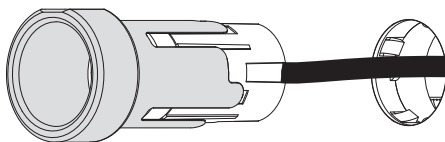

9. Record the location of the 22 System Tool on the provided QR code sticker, and affix it to the circuit directory panel.

