

Device Depth Selection Guide: Alternate Material

Millwork, stone, glass, tile, metal, etc.

Configuration

Use alternate material mounting plates. Either Ø35 plate (22.2.20B) or Ø46 plate (22.2.19B) depending on the device used. Follow through to the next steps to determine device depth.

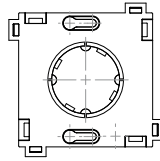

Single Plate — Ø35
22.2.20B

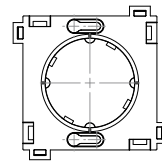

Single Plate — Ø46
22.2.19B

1. Material Thickness

Determine material thickness.

If the material thickness is not standard, select the closest thickness.

6.35mm (1/4")

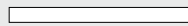

Short

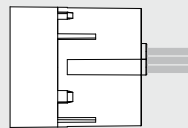

19mm (3/4")



Medium

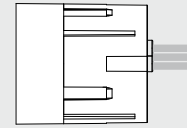

31.75mm (1-1/4")



Long

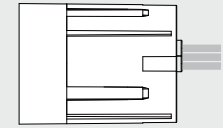

2. Device Depth

All operable devices are available in standard device depth (unless specified otherwise).

Material Type

Is the back end of the material easier to machine down (hardwood, MDF) or shim up (stone, tile) to reach either 6.35mm (1/4"), 19mm (3/4"), or 31.75mm (1-1/4") thickness?

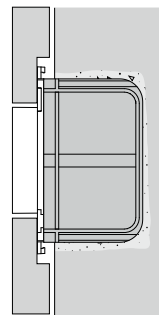

Machine down
(suitable for soft material)

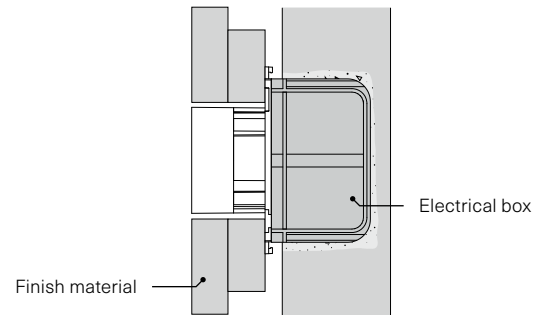

Shim up
(suitable for hard material)

Additions

Depending on the material, there are additional tools you can use to make your installation easier.

Use the trim cap when installing into a wet surface such as tile/grout, plaster, et cetera. One trim cap required per device. They may be reused.

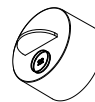

Use a router template for alignment and as a guide for routing. Depending on the material, use with a guide bushing or 36.5mm (1-7/16") / 42mm (1-21/32") Forstner bit, or CNC to cut holes in finish material.

